



AREA STATEMENT

- A. TOTAL AREA OF POCKET - 6.6 HA.
- AREA UNDER RESIDENTIAL PLOTS 2.86 HA 43.3%
- GREEN/PARK 0.66 HA 10.0%
- UTILITY 0.15 HA 2.3%
- CIRCULATION PARKING 2.93 HA 44.4%
- B. DISTRIBUTION OF RESIDENTIAL PLOTS

PLOT AREA	SIZE (IN M)	PLOT NOS	TOTAL PLOTS	AREA (SQ.M)	DU'S	POPULATION
60 SQ.M	50 X 12.0	1-116, 217-246, 635-716	228	13680	912	4104
32 SQ.M	4.0 X 8.0	117-216, 248-267, 270-289, 325-374, 437-486, 515-590, 592-611, 614-633	356	11392	1068	4806
26 SQ.M	3.25 X 8.0	291-324, 375-436, 487-514, 124	324	3224	372	1574
36 SQ.M	4.5 X 8.0	247, 268, 269, 290, 551, 612, 613, 634	8	288	24	108
		TOTAL	716	28584	2376	10632

NET RESIDENTIAL DENSITY 360 DU'S/HA 1620RPPH
C. DEVELOPMENT CONTROL NORMS AS PER M.P.D - 2021

NOTE: IN THE APPROVED LAYOUT PLAN PLOT NO. 678 IS CORRECTED, WHICH WAS INADVERTENTLY SHOWN AS PLOT NO. 688 HAS BEEN APPROVED BY COMM. (PLG.) I DPA ON 18/5/2012 AT PAGE 12 IN FILE NO. DIR. (PLG.) R/4030/P-1/BLK-C/2006. 18/5/2012

NOTE: AS PER FEASIBILITY REPORT RECEIVED FROM EE R.P.D-2 WIDE LETTER NO. F-50(94)02/AE (P)/R.P.D-2/10 DATED 4-1-07, THE SITE IS FEASIBLE AND THE DIMENSIONS HAVE BEEN INCORPORATED IN THE DRG.

LAY OUT PLAN OF RESIDENTIAL POCKET. C-1 SECTOR-30. ROHINI.

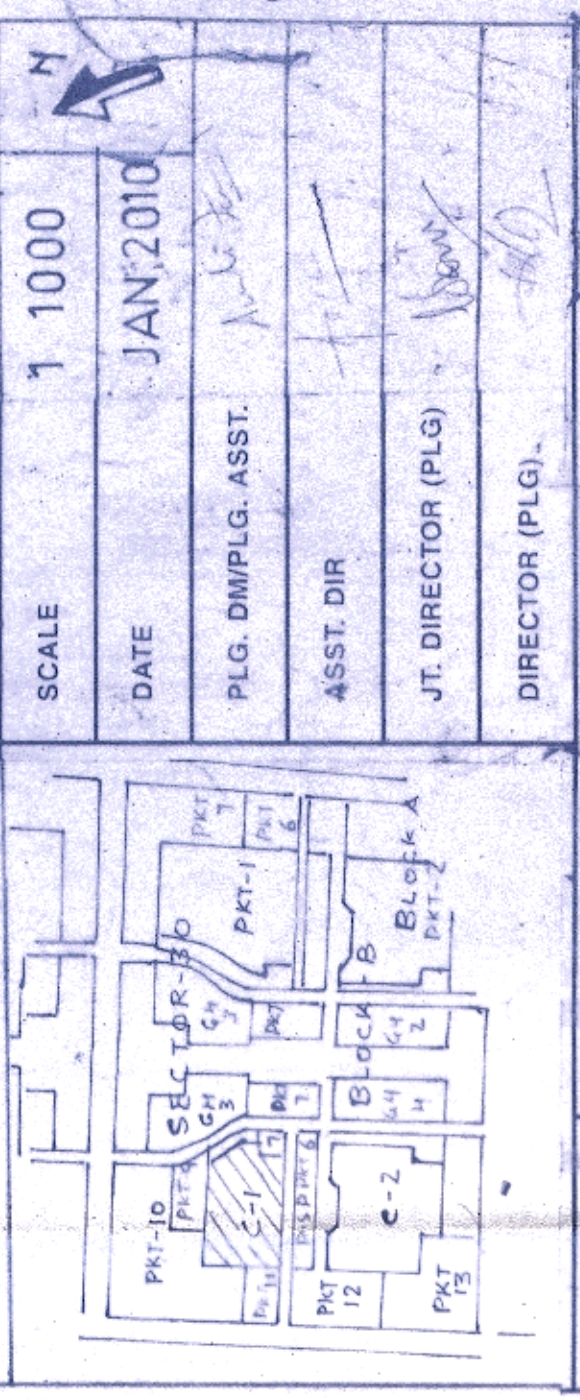

SCALE 1:1000
DATE JAN/2010
PLG. DIR. (PLG.) ASST.
ASST. DIR.
JT. DIRECTOR (PLG.)
DIRECTOR (PLG.)
PROJECT OFFICE NEW DELHI 110085
ROHINI
S-30/PH-V
C-1/1
DRG NO.

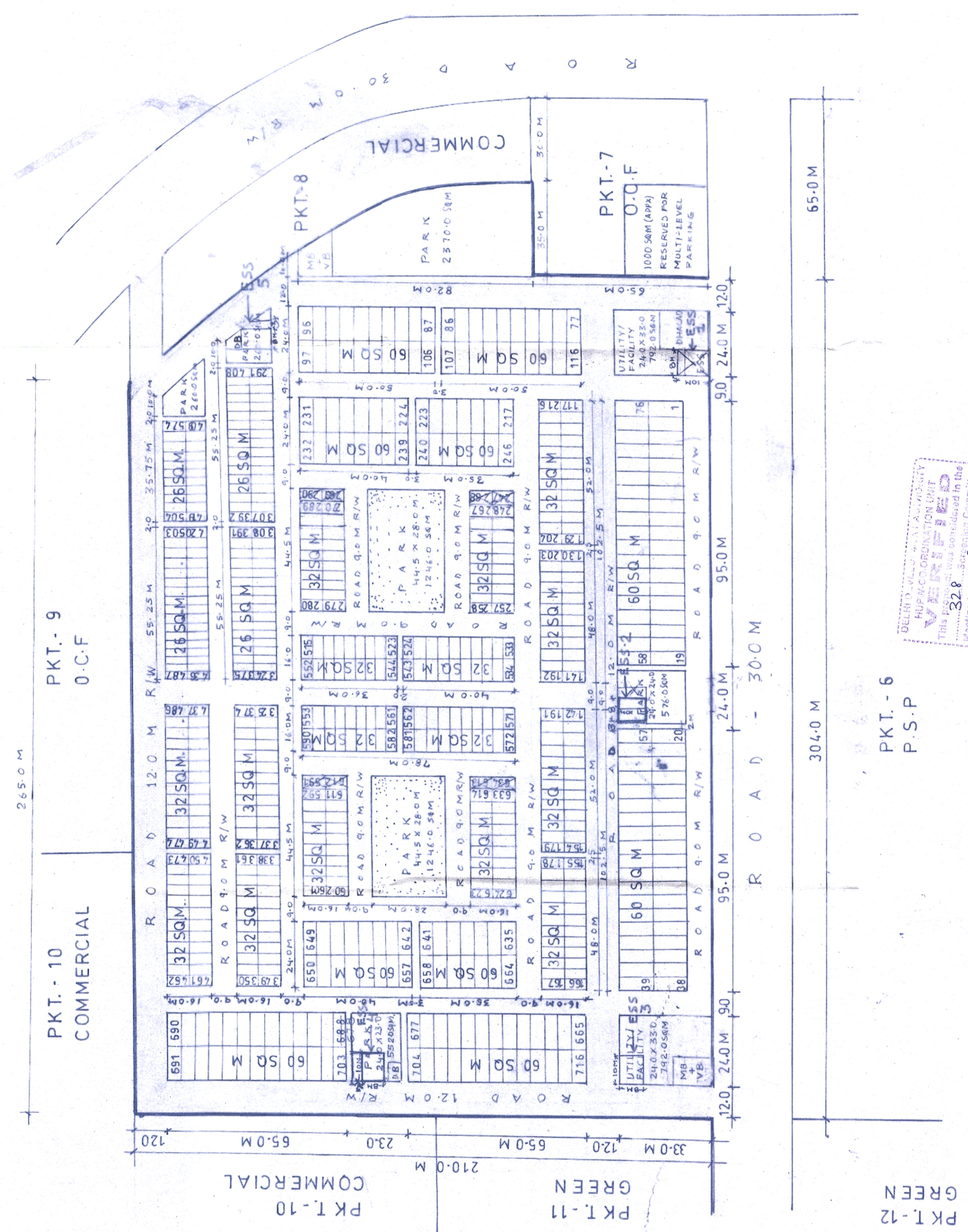

LEGEND

- 11 KV ESS SITES (5 NOS) AREA - 80 SQ.M EACH

* THE LOCATION OF 11KV ELECTRIC SUB-STATION MARKED ON LAYOUT PLAN DULY APPROVED BY TPDDL & FORWARDED BY EX ENGG (E) E.O-9, DDA WIDE LETTER NO. F-3(80)EE (E)/DDA/154 DATED 6-9-2012 HAS BEEN APPROVED IN 308TH SCREENING COMMITTEE MEETING HELD ON 11-10-2012 WIDE ITEM NO 92-2012.

* THE SAME HAS BEEN CERTIFIED BY DIR. (PLG.) ROHINI DATED 23-11-12 AND VERIFIED BY EX DIR. (ARCH.) COORD. DATED 4-12-12 IN FILE NO. DIR. (PLG.) R/4030/SER/15-30/2012.

5 NOS, 11 KV ESS SITES (10 X 8 M) (80 SQ.M EACH) ALLOTTED TO GNCTD WIDE LETTER NO. F-29(05)12/11/1669 DATED 19-8-2014

THE SCHEME WAS DISCUSSED IN THE 289TH SCREENING COMMITTEE MEETING HELD ON 25-02-10 WIDE ITEM NO. 20-2010 IN FILE NO. DIR. (PLG.) R/4030/PKT.1/BLK-C/2006. THE PROPOSAL AS REFLECTED IN THE AGENDA WAS APPROVED.

THE SCHEME WAS APPROVED IN THE 289TH SCREENING COMMITTEE MEETING WIDE ITEM NO 20-2010 AND THE SAME WAS AUTHENTICATED BY EX DIR. (ARCH.) COORD. DT. 6-4-10 IN FILE NO. DIR. (PLG.) R/4030/PKT.1/BLK-C/2006.

NOTE: MINOR MODIFICATION IN ESS NO. 2, 4 & 5 BY PROVIDING 3.0M WIDE PATH ON ONE SIDE IS APPROVED BY EM, DDA, ON 02-01-15, IN FILE NO. DIR. (PLG.) R/2006/SER/530/2012 AT PAGE 12, SUBJECT TO RATIFICATION BY SCREENING COMMITTEE.

NOTE: MODIFICATION IN 11 KV ESS NO. 2, 4 & 5 BY PROVIDING 3.0M WIDE PATH ON ONE SIDE HAS BEEN APPROVED IN 305TH SCREENING COMMITTEE MEETING HELD ON 24-02-2015 WIDE ITEM NO 17-2015 IN FILE NO. DIR. (PLG.) R/2006/SER/15-30/2012.

DELHI DEVELOPMENT AUTHORITY
PROFESSIONAL USE ONLY
VERIFIED
This drawing was prepared in the
Master plan and is subject to the
Wider item number: 17-2-2015
17-2-2015
Director (Arch.)

The proposal has been approved by
the 328th Screening Committee
held on 24-02-2015 in file No. DIR. (PLG.) R/2006/SER/15-30/2012

DELHI DEVELOPMENT AUTHORITY
CERTIFIED
Approved in 328th Screening Committee Meeting on 24-02-2015
Wider Item No. 17-2-2015
Sign: H. K. Bhatnagar
Designation: DIRECTOR (PLG.)

PLG. ASST. ASST. DIR. (PLG.)